

No. of Contacts	DIMENSIONS	
	A	B
3	2.54	4.15
4	3.81	5.42
5	5.08	6.69
6	6.35	7.96
7	7.62	9.23
8	8.89	10.50
9	10.16	11.77
10	11.43	13.04
11	12.70	14.31
12	13.97	15.58
13	15.24	16.85
14	16.51	18.12
15	17.78	19.39
16	19.05	20.66
17	20.32	21.93
18	21.59	23.20
19	22.86	24.47
20	24.13	25.74
21	25.40	27.01
22	26.67	28.28
23	27.94	29.55
24	29.21	30.82
25	30.48	32.09
26	31.75	33.36
27	33.02	34.63
28	34.29	35.90
29	35.56	37.17
30	36.83	38.44
31	38.10	39.71
32	39.37	40.98
33	40.64	42.25
34	41.91	43.52
35	43.18	44.79
36	44.45	46.06

SQPOFY-~~XX~~S2-BX-X
 Number of Contacts
 Double side
 B1 & B2
 Contact Plating

Definition	Code
◎ Gold plated	
flash B 15μ"	F
10μ" E 30μ"	J
◎Standard: B	

SPECIFICATIONS
 Current Rating: 1 Amp
 Insulator resistance: 5000 Megohms min.
 Contacts resistance: 20 m ohms max.
 Dielectric withstanding AC 500 V
 Operating Temperature -40~+105°C
 Max Processing Temp: 230° for 30 seconds
 Contact Material: Phosphor bronze
 Insulator Material: Polyester,UL 94V-0
 ◎Standard:Nylon-6T

Finish:Gold plated
 ◎Standard: Gold flash all over

*Product specifications are subject to change without notice. Please contact sales office for further confirmation.

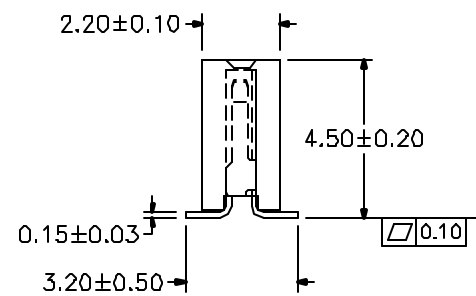
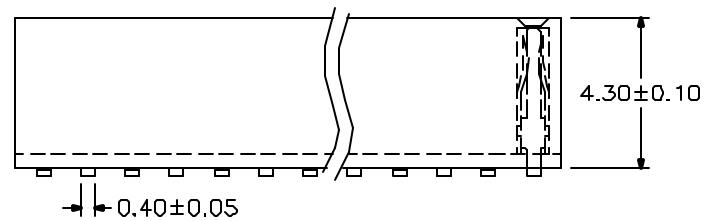
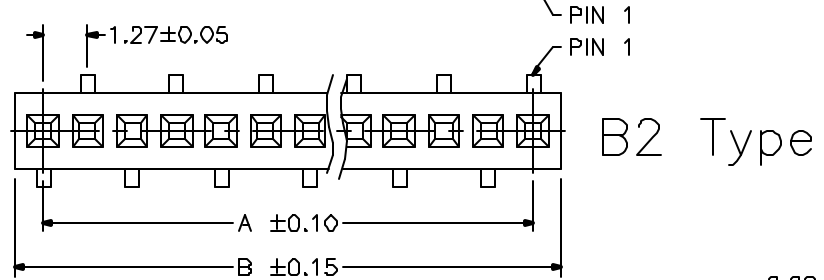
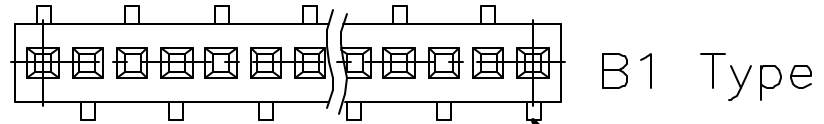

Recommended P.C.Board SMD Layout

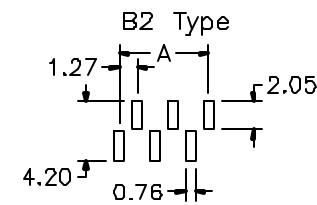
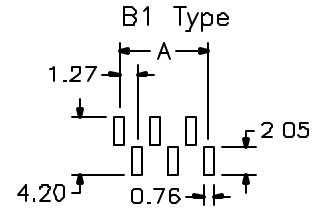

GENERAL TOLERANCE		SCALE 5=1	DRAWN	DATE -08-01'	DWG. NO.	TITLE	REV. 1.0
XX. ±	XXX. ±	UNIT MM	CHECK	DATE -08-01'	F:\DWG\CDWG\SQPOFY\QPDFYMOA.DWG	SQPOFY Series	SHEET
.X ±	.XXX ±	SIZE A4	APPROVE	DATE -08-01'	PARTS NO. SQPOFY-XXS2-BX-X		1/2