

XOY-XXR4-X-S01

No of Contacts	DIMENSIONS	
	A	B
3	2.54	3.81
4	3.81	5.08
5	5.08	6.35
6	6.35	7.62
7	7.62	8.89
8	8.89	10.16
9	10.16	11.43
10	11.43	12.70
11	12.70	13.97
12	13.97	15.24
13	15.24	16.51
14	16.51	17.78
15	17.78	19.05
16	19.05	20.32
17	20.32	21.59
18	21.59	22.86
19	22.86	24.13
20	24.13	25.40
21	25.40	26.67
22	26.67	27.94
23	27.94	29.21
24	29.21	30.48
25	30.48	31.75
26	31.75	33.02
27	33.02	34.29
28	34.29	35.56
29	35.56	36.83
30	36.83	38.10
31	38.10	39.37
32	39.37	40.64

Pin type T

Brass	L
Brass (Reel)	B
Phosphor Bronze	P
Standard: L	

Contact Plating

Definition	Code
◎ Tin plated:	A
◎ Gold plated	
flash B 15μ"	F
10μ" E 30μ"	J
◎ Duplex plating:	
flash K 15μ"	P
10μ" N 30μ"	U
◎ Standard: K	

SPECIFICATIONS

Current Rating: 1 Amp
 Insulator resistance: 5000 Megohms min.
 Dielectric withstanding: AC 500 V
 Operating Temperature: -40°~+105°C
 Max Processing Temp: 230° for 30 seconds
 Contact Material: Copper alloy
 Insulator Material: High Temperature Thermoplastic, UL 94V-0
 Finish: Gold plated
 ◎ Standard: Gold flash all over

*Product specifications are subject to change without notice. Please contact sales office for further confirmation.

Recommended P.C.Board Hole Layout

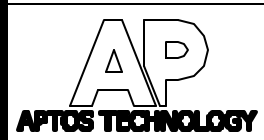
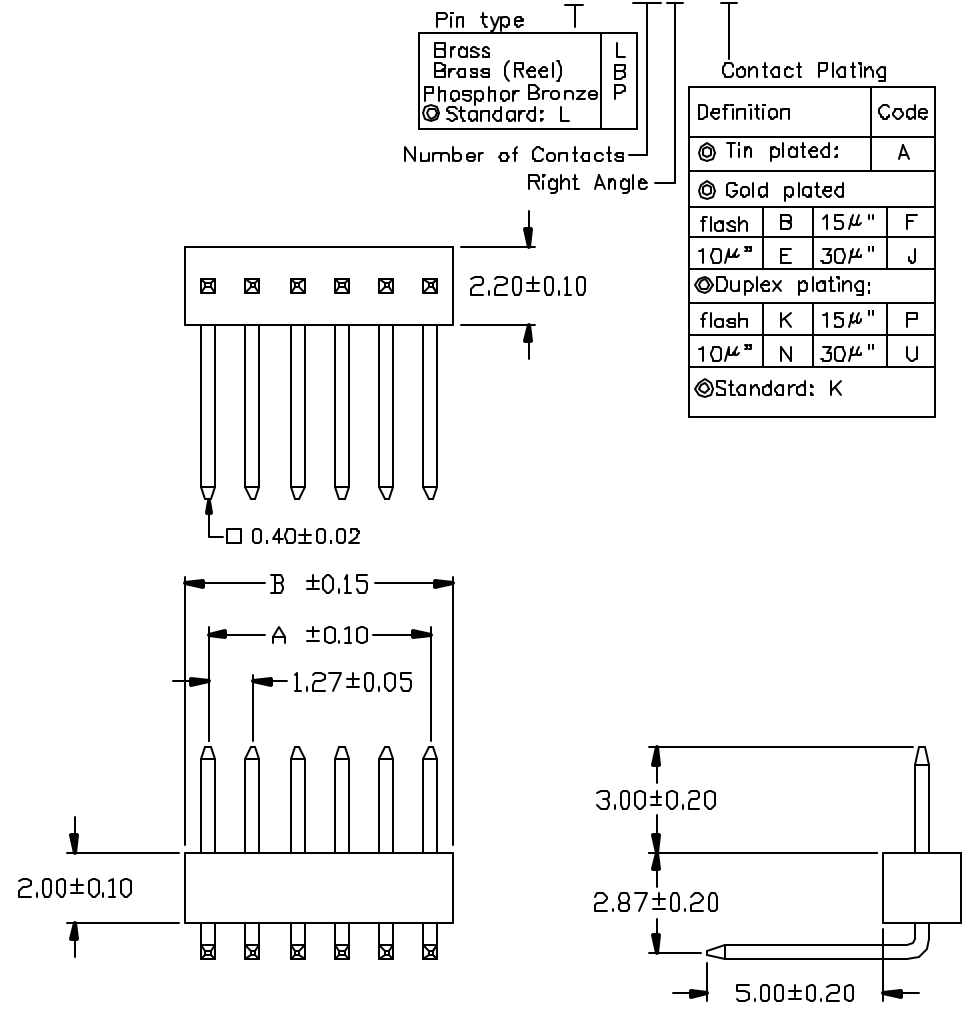
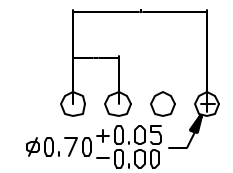

GENERAL TOLERANCE		SCALE 5=1	DRAWN	DATE -02-02	DWG. NO.	TITLE	REV. 1.0
XX. ±	XXX. ±	UNIT MM	CHECK	DATE -02-02	F:\DWG\GDWG\0Y\0YR0B.DWG	XOY Series	SHEET
.X ±	.XXX ±	SIZE A4	APPROVE	DATE -02-02	PARTS NO. XOY-XXR4-X-S01		1/2
.X ±	X. ±						
XX ±	.X ±						