

# VRM8 Shrouded Header

## With Eject Latch Levers

### Dual Row, 40 Circuits

#### APPLICATION AND FEATURES

1. Provides fast connection/disconnection of P.C Board.
2. Mate with series: VRF- connector.
3. Fully shrouded.

#### SPECIFICATIONS

Current Rating: 3 Amps  
 Insulator resistance: 5000 Megohms min.  
 Dielectric withstanding: AC 1000 V  
 Operating Temperature: -40°~+105°C  
 Max Processing Temp: 230° for 30 seconds  
 Contact Material: Copper alloy  
 Insulator Material: Polyester, UL 94V-0

©Standard: Nylon-6T

Finish: Tin, Gold or Duplex plated

©Standard: Duplex plated

©Note:

Duplex plating: gold plated on contact area,  
 Tin on solder area

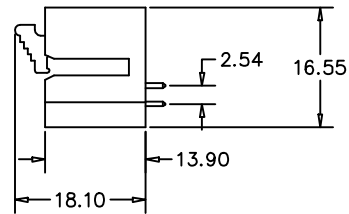
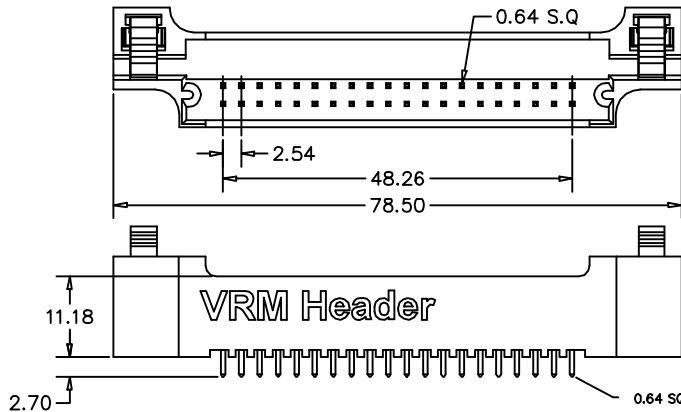
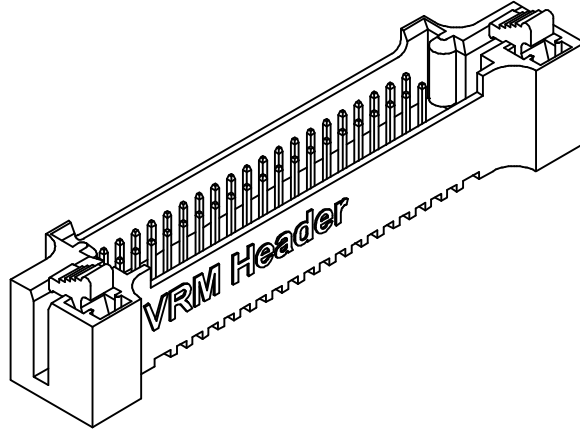

unit:mm

#### How to order

Please replace "X" with appropriate coding listed in the tables below

OLD P/N / NEW P/N  
 (XVRM8) X V R M 8 - X X X - X - 027

Pin type

#### Number of Contacts

No. of contact = Code	
40	
<b>Pin type</b>	
Definition	Code
Pin Material:	
Brass	L
Bronze	B
Phosphor Bronze	P
©Standard: L	

#### Connector Type

Definition	Code
Straight	S

#### Contact Plating

Definition	Code
© Tin plated:	A
© Gold plated:	
flash B 15μ"	F
10μ" E 30μ"	J
© Duplex plating:	
flash K 15μ"	P
10μ" N 30μ"	U
©Standard: K	

#### Recommended P.C.Board Hole Layout

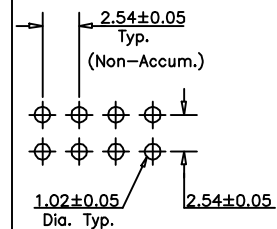

APTOS Technology - (831)-688-0881